

Major Upcoming and Recent Building Projects

Updated December 2017

Guided by principals of craft and innovation, Allied Works Architecture creates designs that resonate with their specificity of place and purpose. Using a research-based approach, Allied Works distills the elemental principles that drive each of their projects and transforms these into material, shape, and structure—architectural designs that engage public imagination and amplify a city’s cultural legacy. The firm has been widely recognized for its building projects in the civic and cultural realm, including the Clyfford Still Museum in Denver, the Contemporary Art Museum St. Louis, and the Museum of Arts and Design in New York; as well as in the private sector, including creative workspaces for Wieden+Kennedy Agency and Pixar Animation, and the Dutchess County Estate, a private residence in Stanfordville, New York.

A selection of major upcoming and recent building projects follows below, including the **National Veterans Memorial and Museum** in downtown Columbus; the expansion of **Providence Park Stadium** in Portland; the **United States Embassy in Mozambique**; the redesign of the World’s Best Restaurant **Eleven Madison Park**; **Fast Retailing’s** global headquarters **“Uniqlo City”**; and the **National Music Centre of Canada’s** new home **Studio Bell**.

Upcoming Projects

National Veterans Memorial and Museum—Columbus, Ohio Opening: Summer 2018



Exterior rendering of the Ohio Veterans Memorial and Museum. Image © Mir

Located on the banks of the Scioto River across from downtown Columbus, the National Veterans Memorial and Museum embraces ideas of service, duty, and remembrance through a fluid architectural design that unites the building with its surroundings. The 55,000-square-foot building, exterior plaza, and its surrounding seven acres of landscaped grounds will become a gathering space for a range of exhibitions as well as commemorative and civic events. The exhibition design, created by Ralph Appelbaum Associates, will lead visitors through a narrative journey exploring core themes and stories related to the veteran experience. Emphasis will be placed on connecting military service to the broader idea of public and community service, fostering a connective dialogue between civilians and veterans. A set of “thematic alcoves” evoking the emotions and challenges of America’s servicemen and -women will serve as the display framework, alongside a dimensional “timeline” detailing the major events and important individuals who have shaped the country’s military history. Moreover, the exhibition is

designed to be accessed by educators as a tool to bring content to life, both on-site and remotely via distance-learning modules.

United States Embassy, Mozambique—Maputo, Mozambique
Opening: Fall 2018



Exterior rendering of the new United States Embassy, Mozambique. Image © Mir

Situated adjacent to the Indian Ocean in the capital city of Maputo, the new United States Embassy in Mozambique spreads across 10 acres and includes nine buildings for working, living, and representational events. The design balances the twinned goals of security and transparency. Site-cast concrete defines the exterior walls of the buildings, while an undulating brise-soleil façade allows in light, air, and views of the surrounding landscape, which transitions from beachfront to forested hills. Covered walkways will facilitate easy movement between different campus locations, including its main chancery building, Marine Security Guard residence, Embassy community facilities, and service buildings—all of which have been carefully arranged to create interior gardens and lawns.

Providence Park Stadium – Portland, Oregon
Opening: 2019 or 2020 Season



Rendering of proposed Providence Park stadium expansion from the historic grandstand © Allied Works Architecture

Allied Works' design plans for the expansion of the historic Providence Park, home to the Portland Timbers and Portland Thorns FC, takes inspiration from the vertical uplift of Shakespeare's Globe Theatre in London. The design puts forth a new model for urban stadiums, adding some 4,000 seats across three levels on the stadium's East side. The structure of open steel lacework creates a sense of transparency and dynamism within and around the stadium, and includes the creation of a striking new covered arcade at street level that enables passersby to share in the energy within. The innovative design ensures that the soccer teams can remain in the heart of downtown Portland, where the stadium has stood since 1926. Construction began in November 2017, with completion of the design expected at the outset of the 2019 season.

Recent Projects

Eleven Madison Park -- New York, NY Opened: October 8, 2017



The Redesigned Eleven Madison Park by Allied Works. Photo © Eric Piasecki.

Allied Works Architecture's design for the renovation and redesign of Eleven Madison Park encompasses the entire dining space of the acclaimed restaurant—heralded as the World's Best—from the interior architecture of the main dining room and bar to the furniture, tableware, and textiles. The project honors and enhances the original Art Deco design of the space, which originally served as the lobby to the landmark Metropolitan Life skyscraper in Manhattan's Flatiron District, facing Madison Park. Working in close collaboration with restaurant co-owners chef Daniel Humm and restaurateur Will Guidara, Allied Works honed a new vision for the space, designed to celebrate and elevate the ritual of dining at every level. The renovation preserves many of the dining room's defining features, amplifying original detail and colors, and includes new bespoke designs, from the tabletop and chairs to hand-tufted rugs and diving screens, all created by Allied Works for the space.

**Uniqlo City, Fast Retailing's new headquarters and flagship creative studio—Tokyo, Japan
Completed: Spring 2017**



Exterior view of Uniqlo City's reading room. Photo by Nacasa & Partners.

The first progressive workspace of its kind in Japan, Uniqlo City is the groundbreaking new headquarters and flagship creative studio for Fast Retailing, one of the world's leading apparel companies. The 200,000-square-foot project—spanning more than four acres of continuous interior space—was planned as a “city” of dynamic and interlaced neighborhoods, with flexible work lofts and communal spaces including libraries, plazas, lounges, and digital information hubs. Uniqlo City fosters collaboration and exchange among employees and supports a dynamic interplay between product development, operations, and distribution around the globe. The design sets a new standard for an international headquarters working across cultures and has served as a creative catalyst for the brand, inspiring new ways of working for Fast Retailing's staff of over 1,000 employees. Located in the Ariake District, on the shore of Tokyo Bay, Uniqlo City is AWA's first project in Asia, and follows the firm's commission in 2013 to create Fast Retailing's creative studio and fabrication facility in New York for the brand's subsidiary labels Theory and Helmut Lang.

**Studio Bell, Home to the National Music Centre of Canada—Calgary, Alberta, Canada
Completed: October 1, 2016**

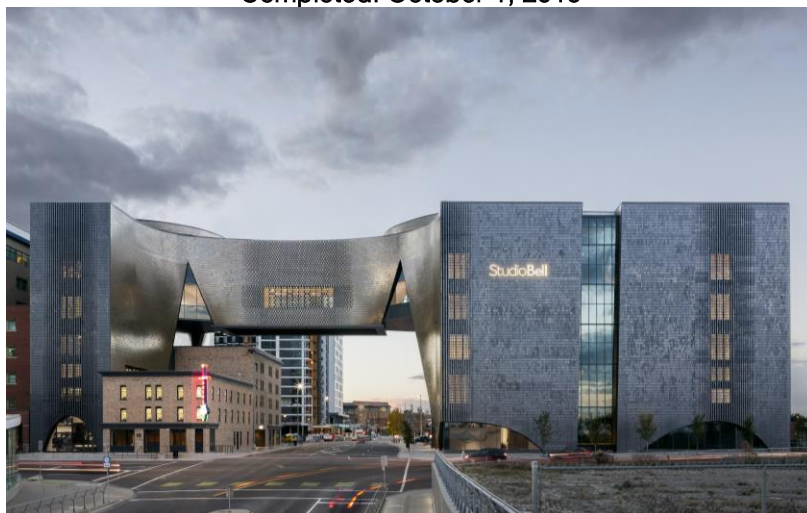

Studio Bell, home to the National Music Centre. Photo Courtesy Jeremy Bittermann.

Canada's National Music Centre (NMC)'s new home, Studio Bell, is first facility of its kind in North America and the first to be dedicated to music in Canada in all its forms. Located in Calgary, Alberta, at the site of the legendary blues club in the historic King Edward Hotel, Studio Bell connects visitors with Canada's rich musical history through live performances, exhibitions, and interactive education programs. Allied Works' design for the 181,400-square-foot cultural center fully restores and integrates the "King Eddy" within a singular and innovative structure, comprised of nine interlocking towers clad with glazed terra cotta. The building design references the form of musical instruments, while providing sweeping views of the Bow River and surrounding cityscape. Exhibition galleries—or "stages"—spread across Studio Bell's five floors, showcase elements of NMC's 2,000-plus-piece collection of instruments, textiles, and technology. Each stage is envisioned as a space for performance, where music is heard and experienced. Local audiences previewed the new cultural center through a phased launch of its exhibitions and programs beginning in July 2017, culminating in the institution's programmatic and architectural completion in October. The Studio Bell commission was awarded to Allied Works in 2009, as the result of an international search and design competition.

For more information or images please contact:

Resnicow and Associates

Juliet Sorce: jsorce@resnicow.com, 212-671-5158

Megan Ardery: mardery@resnicow.com, 212-671-5178

Stephanie Yeo: syeo@resnicow.com, 212-671-5161